



## LEVERLESS HVE

Mfc #: MAK 1150

---

### INSTRUCTIONS FOR USE | ASSEMBLY | DISSASSEMBLY

---

#### PRODUCT DESCRIPTION

An exclusive Anodia Systems design, the Leverless HVE's smooth body contour and hidden valve enables an on/off feature by sliding the body of the valve back and forth. The aseptic design combined with user-friendly features promotes efficient and effective evacuation.

---

#### INSTRUCTIONS FOR USE

1). To open the valve, slide the body and the base together. To close the valve, slide them apart (Figure 1). The valve remains closed when hung by the body.

2). Attach assembled Leverless HVE to suction hose. Ready to conduct general dentistry.

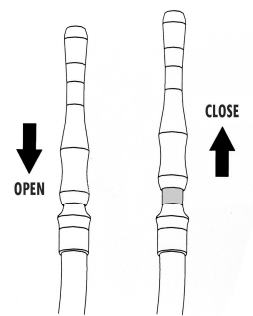

**Figure 1**

---

#### ROUTINE CARE

After each patient, disconnect the valve from the swivel on the tubing and take the complete valve to the sterilization area. Install a clean, sterile Leverless HVE in its place.

## Leverless HVE (MAK-1150) Instructions

### DISINFECTING & STERILIZING

---

To disassemble valve, pull the body from the base. Insert the provided bottle brush up and into the base and push the stem up and out of the tip of the body. This procedure may be done while the valve is submerged in water to facilitate rinsing and avoid splatter. Rinse and brush well prior to placing in an autoclave bag. Autoclave according to your normal protocol.

### IMPORTANT

After sterilization, lubricate the two o-rings on the stem and the o-ring within the base with a lubricant such as Vaseline. Reassemble the valve as directed in 'Assembly.'

Steam autoclave, Dry Heat, Ethylene Oxide, and Gas or Chemical Vapor process are all safe to use, as long as temperatures do not exceed 280 degrees Fahrenheit (138 Celsius).

NOTE: If you use the chemical vapor process, the valve must first be thoroughly rinsed of all cleaning agents. Cleaning agents left on the valve may react with the chemical vapor solutions to form a crystalline residue which can clog the valve or cause it to stick.

### ASSEMBLY

---

- 1). The Leverless HVE is composed of four parts: quick-disconnect swivel (QD), base, body, and O-ring cleaning insert (Figure 2).

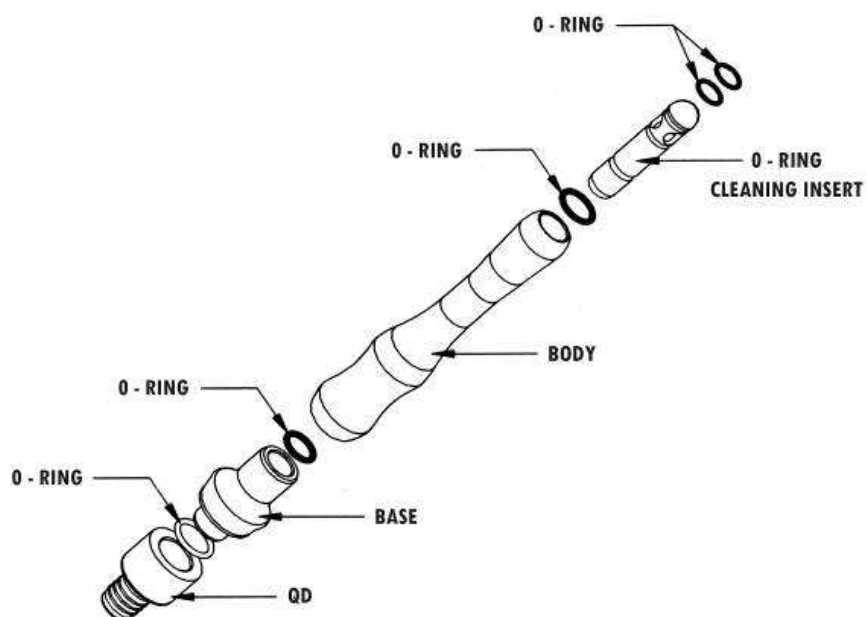

Figure 2

## Leverless HVE (MAK-1150) Instructions

2). To **Assemble**, place body onto base in an upright position (Figure 3).



**Figure 3**

3). Hold the body and base together with one hand and then with your free hand, slide the O-ring cleaning insert into the narrow end of the body, with O-rings facing up (Figure 4).



**Figure 4**

4). Slide the blunt handle of a dental instrument into the narrow end of the body until it makes contact with the O-Ring cleaning insert (Figure 5). Push firmly on the insert until it snaps into place. (A soft click is heard as the O-ring in the base snaps into place). When it does, it will move about one half of an inch.

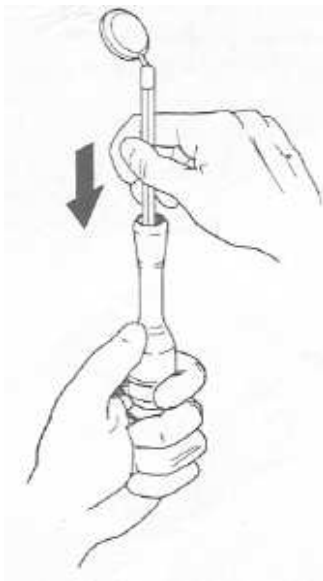

**Figure 5**

5). Leverless HVE is now ready to use. Attach to the QD in dental operator.

Note: if assembled valve falls apart, review steps. It is likely that the O-ring cleaning insert is not properly snapped in place or it is upside down.

### DISASSEMBLY

---

1). To disassemble the valve, pull gently on the body and base attachment until they separate (Figure 6).



**Figure 6**

2). The O-ring cleaning insert will be protruding from the end of the body. Push on the stem and tilt the narrow end of the body downward into the palm of your hand (Figure 7). The insert will slide out of the body.



**Figure 7**